



- 1 A New Two Track Bridge Over the Potomac River
- 2 A New Bicycle Pedestrian Bridge Over the Potomac River
- 3 A New Two Track Bridge Over I-395
- 4 A New Four Track Bridge Over Ohio Drive SW
- 5 A New Four Track Bridge Over the Washington Channel
- 6 A New Four Track Bridge Over Maine Avenue SW
- 7 A New Pedestrian Bridge Over Maine Avenue SW

### PROJECT SUMMARY

The Virginia Passenger Rail Authority's Long Bridge Project will construct a new two-track railroad bridge next to the existing Long Bridge across the Potomac River. The new rail bridge will unclog a major transportation bottleneck between the north and south regions of the U.S., improving reliability and growing the nation's passenger and freight networks.

The project will also build a bicycle and pedestrian bridge over the river, connecting Arlington's Long Bridge Park and the Mount Vernon Trail to the District's East and West Potomac Parks. Improvements along the 1.8-mile project corridor include five rail bridges and two pedestrian/bicycle bridges.

### PROJECT BENEFITS

- Increased rail capacity that enables more frequent passenger rail service with better on-time reliability.
- Improved bicycle and pedestrian connectivity between Northern Virginia and DC with a new sixteen-foot-wide bicycle-pedestrian bridge.
- Billions of dollars invested in the regional economy.
- Infrastructure improvements that increase safety and security along the project corridor.

### CONSTRUCTION TIMELINE

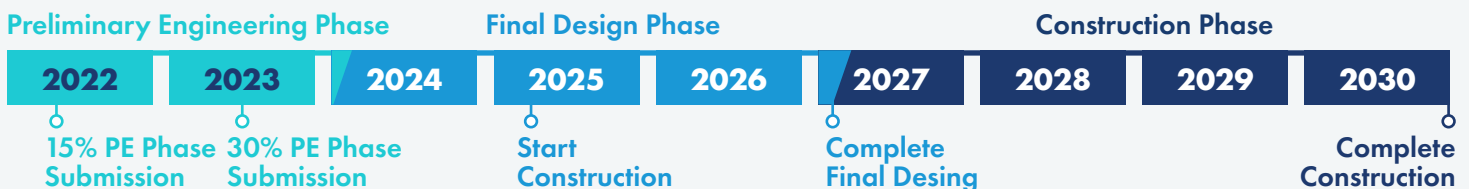

### KEEP TRACK OF PROJECT UPDATES

[www.longbridgeproject.com](http://www.longbridgeproject.com)

Email: [info@LongBridgeProject.com](mailto:info@LongBridgeProject.com)

Call: (202) 769-1808

 /VAPassengerRail

 @VAPassengerRail

 Virginia Passenger Rail Authority



SCAN ME!

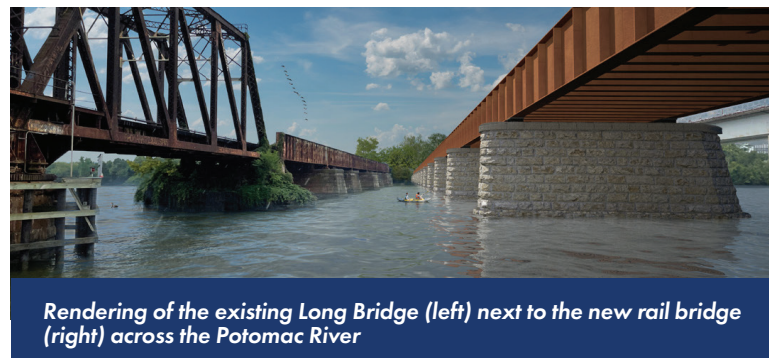



## CONSTRUCTION ACTIVITIES

VPRA's commitment to the community is to make every reasonable effort to keep construction impacts to a minimum while building the project as efficiently and safely as possible. Plans and processes are in place to proactively inform the public and other stakeholders in advance of construction activities that are particularly impactful and to minimize surprises.

Pre-construction activities include archaeological testing, vibration monitoring, borings, test piles, and tree and brush clearing.

### Maine Avenue SW Access Road to 14th Street SW

Travelers will see impacts at Maine Avenue and the access road to 14th Street SW during construction of the new four track rail bridge and new Maine Avenue pedestrian bridge.

In August 2025, the Maine Avenue SW Access Road to 14th Street SW was closed to thru traffic. It is part of the work zone and the northern section now operates as a two-way street. **Until 2030, the access road will:**

- Only be accessible from D Street.
- Primarily act as a private access with significantly less traffic volume.
- Not include any on-street parking.
- Maintain uninterrupted access to the garage and delivery locations.

### Maine Avenue

Construction on Maine Avenue will require two temporary traffic patterns to maintain vehicle and pedestrian access, and work will be completed in four major phases, as shown in the timeline below. The graphics to the right show the traffic patterns that will be in place. The Westbound Construction Traffic Pattern is currently implemented. The exclusive right turn lane on westbound Maine Avenue SW is closed from just beyond the entrance to the Salamander Hotel to the 14th Street bridge. **During construction:**

- Occasional nighttime lane closures and weekend detours may occur.
- The 14th Street Ramp to Maine Avenue will be temporarily closed at times.
- The pedestrian bridge crossing will be maintained via a temporary pedestrian bridge near the marina entrance while the new bridge is constructed.

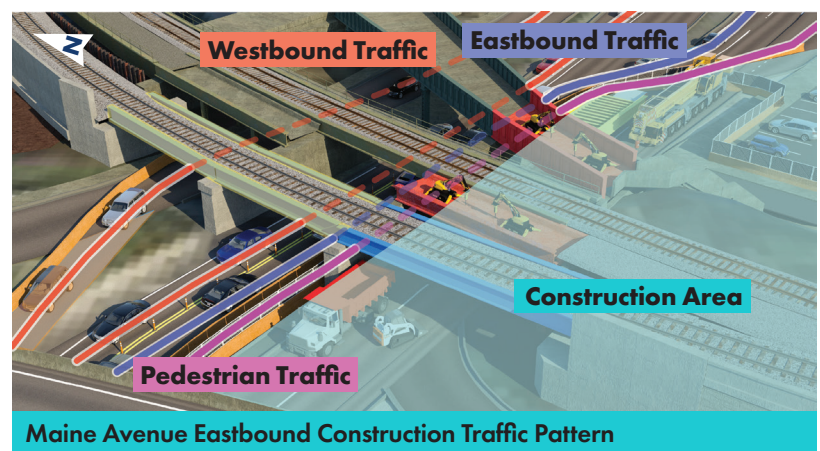
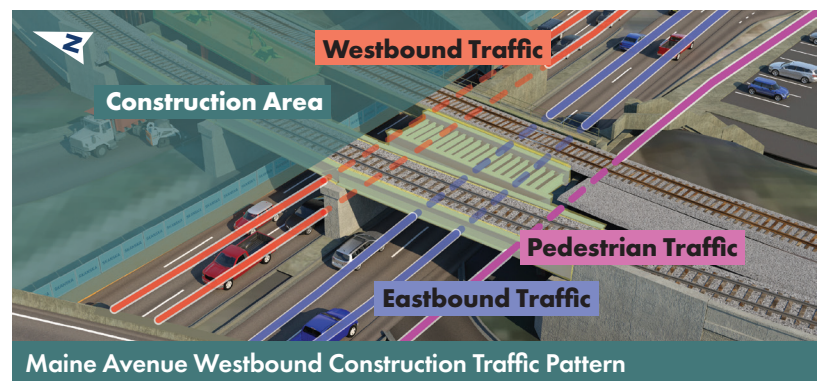
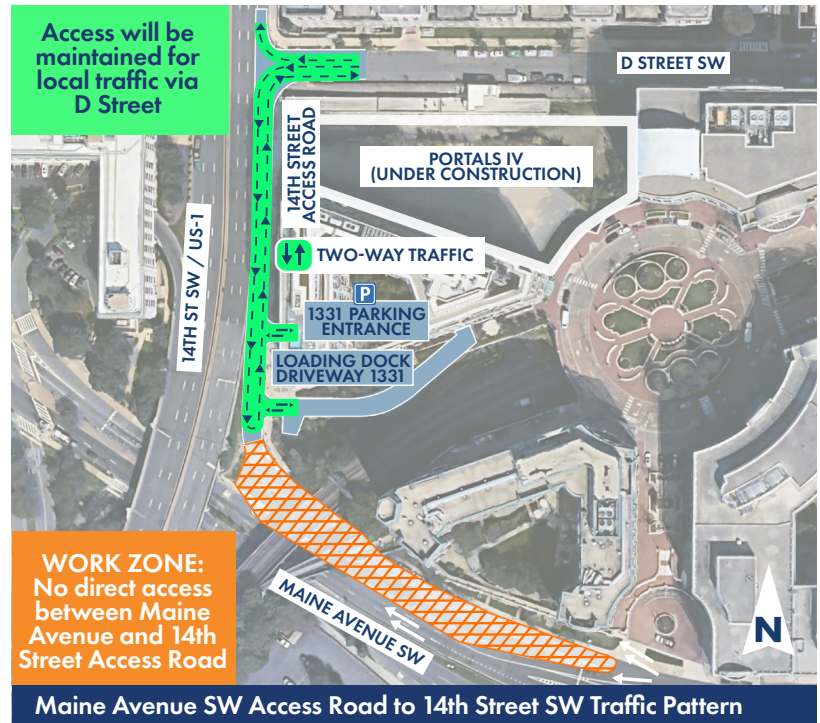

### Maine Avenue Construction Phases - Preliminary Schedule

